

BRASS SASH PULLEY



- PART # HSP2.5-606 2 1/2" BRASS SASH PULLEY W/ BALL-BEARING
(SATIN BRASS NO LACQUER)
- PART # HSP2.5-613 2 1/2" BRASS SASH PULLEY W/ BALL-BEARING
(DARK OXIDIZED BRASS NO LACQUER)

High quality manufactured sash pulley. Made with a brass face plate, riveted to a steel wheel housing. The brass machine-turned sash pulley rotates around a precision sealed ball-bearing rated at 1300 lbs dynamic load. The bearing and wheel assembly are pressed together, and a 5/16" hollow end rivet is riveted through the housing to secure the assembly. An economical and high quality alternative to our cast pulley.

BRASS SASH PULLEY

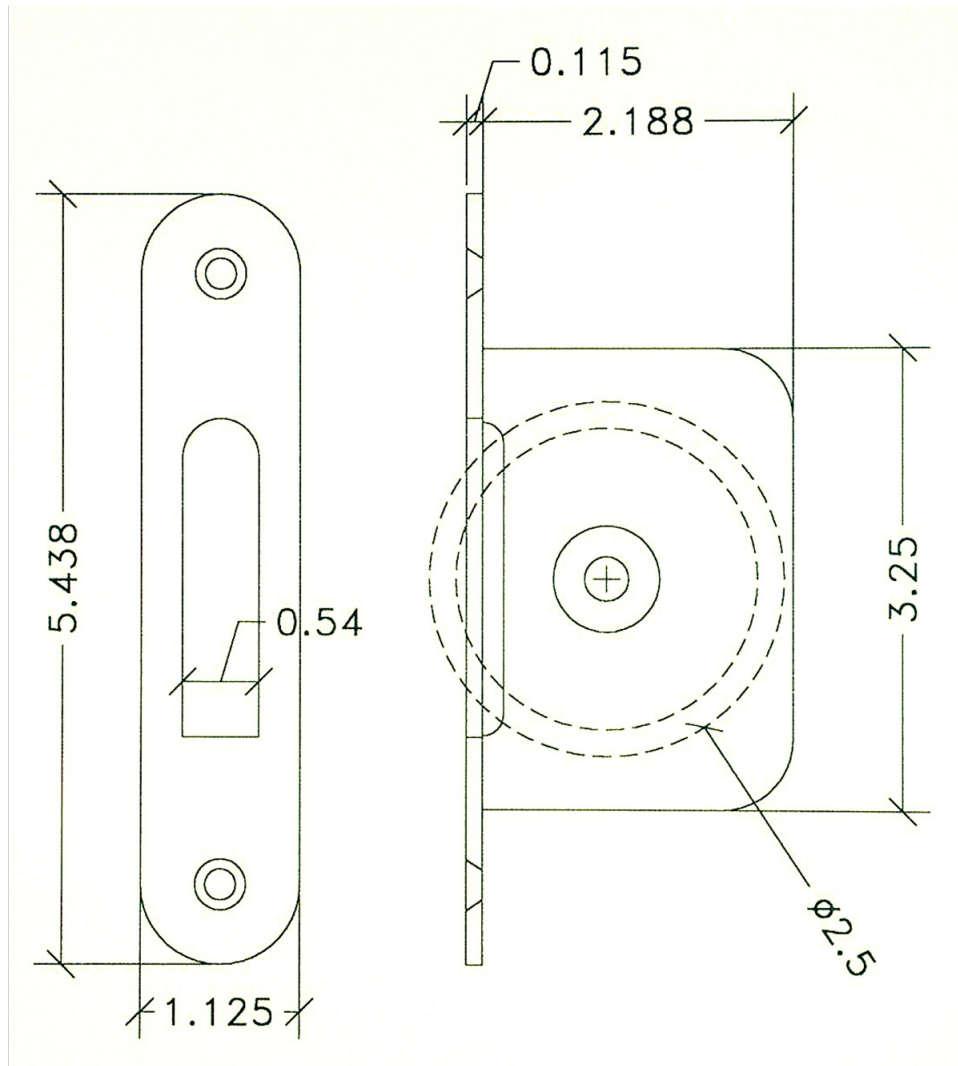

DRAWING NOT TO SCALE

- PART # HSP2.5 (ALL FINISHES) 2 1/2" BRASS SASH PULLEY W/BALL-BEARING

EDITION 4.0h



P2A